

Ref.	Description	Product Quantity	Item Number	Kit No.(s)
004	Indicator assy	1	A30151022	
006	Std ms hex hd bolt M16 x 120 lg	1		
007	Std ms hex thin nut M16	1	218961414	
008	Sub-assy - coupling cover cooling coil	1	A30751010	
009	Sub-assy - gear cover cooling coil	1	A30751011	
010	Sub-assy intercooler	1	A30751012	
011	Trapped 'O' ring ISO 100	1	B27158171	
012	Trapped 'O' ring ISO 160	1	B27158172	
013	Compression ring	3	A27820008	
014	Stator	1	A30751001	
015	Headplate - gear end	1	A30750002	
016	Headplate - coupling end	1	A30751003	
017	Gear cover	1	A30750004	
018	Coupling cover	1	A30752032	
019	Fluid coupling (driven)	1	A30751036	
020	Sump cover plate	1	A30751014	
021	Sump cover blanking plate	1	A30751015	
022	Bearing carrier - gear end	2	A30751016	
023	Bearing carrier - coupling end	2	A30751017	
024	Throw ring - coupling end	2	A30751018	
025	Throw ring - gear end	2	A30751019	
026	Seal carrier - left hand	2	A30751020	
027	Seal carrier - right hand	2	A30751021	
028	Fluid coupling (driver)	1	A30751030	
029	Coupling enclosure	1	See Table 15	
030	Shim 0.05mm thick	A/R		11
031	Shim 0.10mm thick	A/R		11
032	Shim 0.20mm thick	A/R		11
033	Sleeve (conical/pre-conical)	1/2	A30751034/ A27802032	8, 9
034	Drive 10 hp		See Table 15	
035	Ball bearing 6309RS	4		10
037	Inner ring - ir 45 x 55 x 22	4		10
038	Dust seal	4		10
039	Filter disc	6		10
040	Gears	1PR	A22903012	
041	Key 10 x 8 x 30mm lg	1	A24301026	
042	'Heyco' plug (plast)	2	A25908024	
043	Cover plate	1	A25942014	
044	Gear cover baffle	1	A25970013	
045	Coupling baffle	1	A25970014	
046	Oil reservoir cover	1	A25970015	
047	Evacuation baffle	2	A25970022	
048	Bearing retainer	4	A25971008	

Table 12 - EH2600 Pump parts list

Ref.	Description	Product Quantity	Item Number	Kit No.(s)
049	Retainer (2 halves)	2	A25971009	
050	Seal retainer	1	A25971010	
051	Sight glass reflector	3	A25976001	
052	Breather plug 1" BSP	1	A25908176	
053	1/2" BSP plug - EH2600/2600IND	7	A26002021	
	1/2" BSP plug - EH2600C/2600T160/2600 T3	6	A26002021	
054	Rotor (driver)	1	A26401020	
055	Rotor (driven)	1	A26401021	
056	Thrust ring	1	A26407008	
057	Thrust ring	1	A26407009	
058	Thrust ring	4	A26407010	
059	Locking element - 'Ringfeder'	4PR	A26440003	
060	1" BSP Dowty washer	1		8,9
061	Disc spring K6013, 99 X 70.5 X 1.0	12	21898-5237	
062	Gasket (Viton)	1		8,9
063	Clamp ring	2	A27801003	
064	Cooling coil spacer	6	A27802003	
065	Scr hex hd M16 x 60	1		
066	Sight glass (glass)	3		8,9
067	Sight glass bezel (plast)	3	A25908100	
068	Tube - 12mm o/d copper	1	A27843009	
069	Tube - 12mm o/d copper	2	A27843010	
070	'O' ring size ref 0111-16 (Viton)	1	H02122009	
071	Loctite 518	A/R		
072	Lipseal - 72 X 55 X 10 (PTFE)	4		10
073	Oil splasher	1	A25970019	
074	Label	1	A20001219	
075	Lipseal - 45 X 60 X 10/8 (PTFE)	1	23741-069	
076	'O' ring 15.1 i/d x 2.6mm section	1		10
077	'O' ring 1.046" i/d x .139" section	6		8,9
078	'O' ring 1.234 i/d x .139" section	6		8,9
079	'O' ring 19.5 i/d x 3mm section	7		8,9
080	'O' ring 74.5 i/d x 3mm section	4		10
081	'O' ring 419.3 i/d x 5.7mm section	2		8,9
082	Male stud coupling 12mm o/d 3/8" BSPT	1	H03505043	
083	Male stud elbow 12mm o/d 3/8" BSPT	3	H03505111	
084	Hex locknut 3/4" BSP	6	M01500011	
085	Plastic insert	1	A25908035	
086	Rivet	6	211430301	
087	Taper pin Ø 8 X 36 lg	4	212192021	
088	Label 'Vented' (plast)	1	A20001195	
089	Std ms hd scr M5 x 10 lg	1		
090	Std ms hex hd scr M10 x 35 lg	8		
091	Std ms hex hd scr M6 x 20 lg	24		

Table 12 - EH2600 Pump parts list (continued)

Ref.	Description	Product Quantity	Item Number	Kit No.(s)
092	Std ms csk hd scr M5 x 10 lg	9		
093	Soc hd cap scr M5 x 10 lg	3		
094	Std ms hex hd scr M8 x 25 lg	8		
095	Std ms hex hd scr M8 x 30 lg	24		
096	Std ms hex hd scr M10 x 16 lg	4		
097	Std ms hex hd scr M12 x 30 lg	4		
098	Std ms hex hd scr M16 x 35 lg	5		
099	Soc hd cap scr M8 x 10 lg	2		
100	Soc hd cap scr M6 x 25 lg			
101	Soc hd cap scr M10 x 30 lg			
102	Std ms plain washer M8			
103	Std ms plain washer M10			
104	Std ms plain washer M12	4		
105	Std shakeproof washer M12	4		
106	'O' ring 239.5 i/d x 3mm section	1		8,9
107	Loctite 641	A/R	11753-039	
108	Moly disulphide grease	A/R		
109	Loctite 'Screwlock'	A/R		
110	Redcap	2	H01503021	
111	Blanking flange ISO 100	1	A52908143	
112	Blanking flange ISO 160	1	A52908144	
113	Modified cap (Rubber)	1	A30151024	
114	Retainer	1	A30751033	
115	Ring (Viton)	1	A27159441	
116	Eyebolt M16 (to drg spec)	2	218790007	
117	Stud M8	2	B22402003	
118	Angle	1	A20103004	
119	Spacer	2	A27801007	
120	Std ms hex nut M8	2		
121	Warning label 'Electrical'	1	E20001063	
122	Label 'Direction of rotation'(plast)	1	A20001085	
123	Seal 40-52.7 (Viton) (drg spec)	4/2		8,9
124	Scr pan hd M5 x 10 lg (st stl)	22		
125	Std plain wshr M5 (ms ni)	8		
126	Std shakeproof washer M5	8		
127	Warning label (plast)	1	A20001200	
128	Label	1	A20001209	
129	Nut full M16	4		
132	Label 'Fomblin oil only'	2	A20001275	
135	'O' ring 109.5 x 3.0 (Viton)	1	H02122091	
136	Filler plug purge adaptor - EH2600C/T3/ T160 only	1	A30555005	
137	Warning label 'Hot surface'	3	A20001286	

Table 12 - EH2600 Pump parts list (continued)

14 EH4200 PUMP PARTS LIST

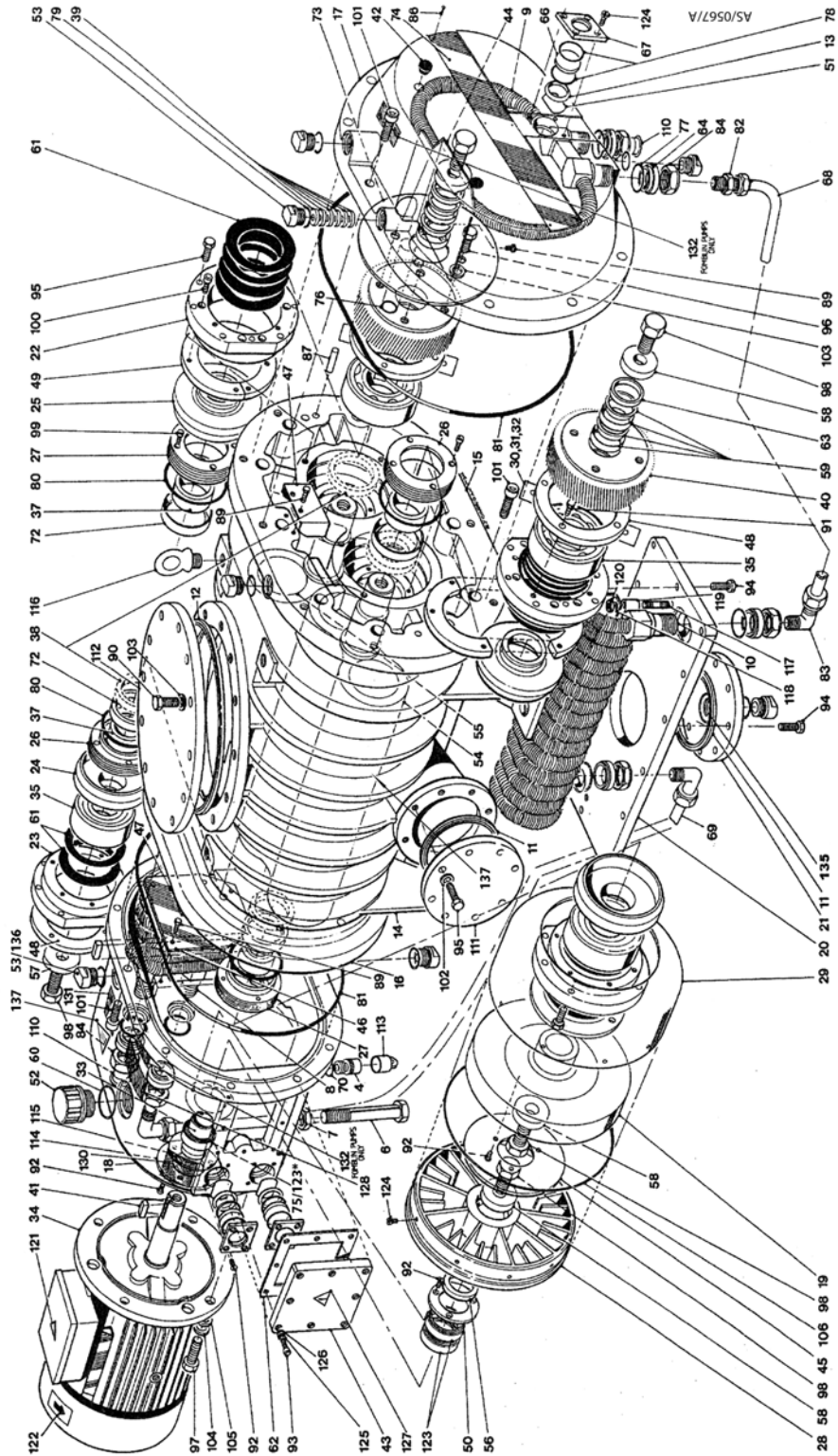

Figure 13 - EH4200 Pump

Ref.	Description	Product Quantity	Item Number	Kit No.(s)
004	Indicator assy	1	A30151022	
006	Std ms hex hd bolt M16 x 120 lg	1		
007	Std ms hex thin nut M16	1	218961414	
008	Sub-assy - coupling cover cooling coil	1	A30751010	
009	Sub-assy - gear cover cooling coil	1	A30751011	
010	Sub-assy intercooler	1	A30951002	
011	Trapped 'O' ring ISO 100	1	B27158171	
012	Trapped 'O' ring ISO 250	1	B27158143	
013	Compression ring	3	A27820008	
014	Stator	1	A30951001	
015	Headplate - gear end	1	A30750002	
016	Headplate - coupling end	1	A30751003	
017	Gear cover	1	A30750004	
018	Coupling cover	1	A30752032	
019	Fluid coupling (driven)	1	A30751036	
020	Sump cover plate	1	A30751014	
021	Sump cover blanking plate	1	A30751015	
022	Bearing carrier - gear end	2	A30751016	
023	Bearing carrier - coupling end	2	A30751017	
024	Throw ring - coupling end	2	A30751018	
025	Throw ring - gear end	2	A30751019	
026	Seal carrier - left hand	2	A30751020	
027	Seal carrier - right hand	2	A30751021	
028	Fluid coupling (driver)	1	A30751030	
029	Coupling enclosure	1	See Table 15	
030	Shim 0.05mm thick	A/R		11
031	Shim 0.10mm thick	A/R		11
032	Shim 0.20mm thick	A/R		11
033	Sleeve (pre-conical/conical)	2/1	A27802032/ A30751034	8,9
034	Drive 10 hp	1	See Table 15	
035	Ball bearing 6309RS	4		10
036	Sleeve (conical)	1	A30751034	
037	Inner ring - ir 45 x 55 x 22	4		10
038	Dust seal	4		10
039	Filter disc	6		10
040	Gears	1PR	A22903012	
041	Key 10 x 8 x 30mm lg	1	A24301026	
042	'Heyco' plug (plast)	2	A25908024	
043	Cover plate	1	A25942014	
044	Gear cover baffle	1	A25970013	
045	Coupling baffle	1	A25970014	
046	Oil reservoir cover	1	A25970015	
047	Evacuation baffle	2	A25970022	
048	Bearing retainer	4	A25971008	

Table 13 - EH4200 Pump parts list