

ConvecTorr™ Gauge531 Thermocouple and 536 Baffled Thermocouple



The 531 Thermocouple Gauge Tube is the time-proven, low-cost solution for continuous and accurate indication of rough vacuum pressure from 1×10^{-3} to 2.0 Torr (1×10^{-3} mbar to 2.7 mbar). Featuring rugged dependability and consistent operation unaffected by mounting orientation.

The 536 Thermocouple Gauge Tube is a welded 304 stainless steel version of the 531 with an additional baffle that greatly extends the sensor life when exposed to condensable gases in demanding applications. It provides a continuous and repeatable indication of pressures from 1×10^{-3} torr to 2 torr (1×10^{-3} mbar to 2.7 mbar). The thermocouple and heater are noble metal to minimize any possible affect of contaminants on gauge performance.

Both gauges are offered in a variety of mounting options and are easily interfaced with Varian's XGS-600 gauge controller.

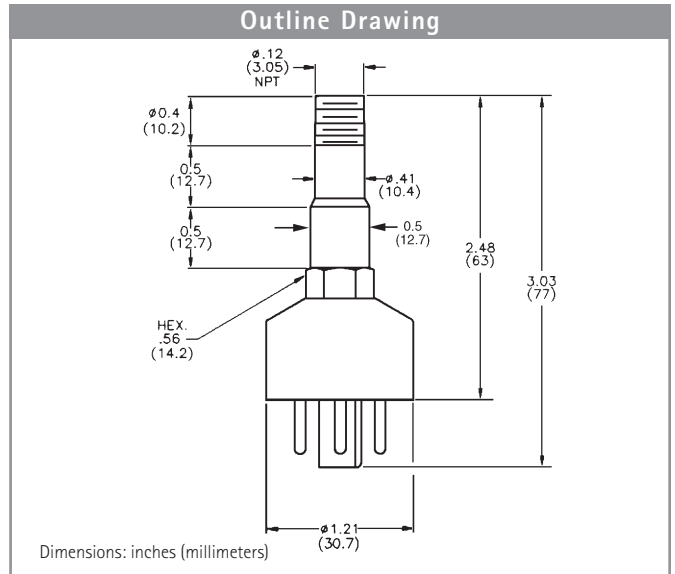

Technical Specifications

Measurement Range

1×10^{-3} Torr to Atmosphere, 1×10^{-1} to 133 Pascal

Temperature Limits

Operating: 0 °C to 50 °C; Storage: -15 to 80 °C; Bake out: 150 °C with cable disconnected

Pressure Response Time

Less than 3 seconds

Ordering Information

Description	Part Number	Fitting	Weight lbs. (kg)
531 Thermocouple Gauge Tube	F0472301	1/8 in. NPT	1.0 (0.5)
536 Thermocouple Gauge Tube			
Baffled TC tube type 304 stainless steel	L6141303	1/8 in. NPT	1.0 (0.5)
Platinel filament	L6141304	Mini-ConFlat	1.0 (0.5)
	L6141305	Cajon 4 VCR (female)	1.0 (0.5)
	L6141307	NW10 KF	1.0 (0.5)
	L6141308	NW16 KF	1.0 (0.5)
	L6141309	NW25 KF	1.0 (0.5)